

Concealed slides for wooden drawers.



FOLLOW US

dyna moov.

The slide system for a load capacity of 30 kg.

The economical alternative for those who do not want to compromise when it comes to running characteristics.

Feel more WOW.

G*GRASS®

With a branded product, you know what you're getting. That's where GRASS is the best example. Our premium-quality movement systems combine technological advances, comfortable functionality, top quality and precision through to the smallest detail.

grass.eu



Dynamoov.
Simple. Good.
Economical.



Dynamoov

Slide System

Synchronised full extension slide with integrated height adjustment and 30 kg load capacity.
Slide-on assembly.

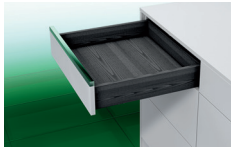
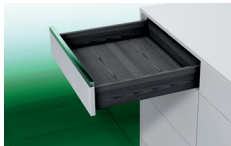
	Product description	Page
	Dynamoov full extension slide 30 kg Soft-close <ul style="list-style-type: none"> • Soft-close damping system • Integrated tool-free height adjustment, + 3.5 mm 	4
	Dynamoov full extension slide 30 kg Tipmatic <ul style="list-style-type: none"> • Tipmatic opening system • Integrated tool-free height adjustment, + 3.5 mm • Integrated front gap adjustment + 1.5 mm 	6
	Technical information	8
	Assembly aids	10

DYNAMOOV SOFT-CLOSE

Full extension slide 30 kg



- Excellent running characteristics
- Fully synchronised slide technology
- Soft-close damping system
- Stepless self-locking of the drawer when pushed onto the slide
- Integrated height adjustment, tool-free + 3.5 mm
- Optional depth adjustment + 3.5 mm

ORDER INFORMATION

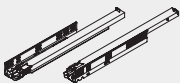
1		Dynamooov full extension slide Soft-close		Set: one left, one right			
NL	30 kg						
	Art. No.						
250	F130107760						
270	F130107761						
300	F130107764						
320	F130107767						
350	F130107768						
380	F130107771						
400	F130107772						
420	F130107775						
450	F130107776						
480	F130107779						
500	F130107780						
520	F130107783						
550	F130107784						
600	F130107787						

2		Front locking device (1D)		Set: one left, one right			
		Art. No.					
		F134140216					

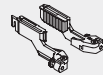
Optional: depth adjustment (1D)		Set: one left, one right			
		Art. No.			
		F134101313			

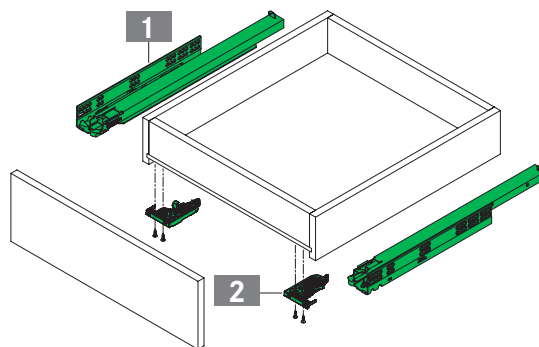

PAGE REFERENCES

Technical information	8		
Assembly aids	10		

PLANNING DIMENSIONS

All dimensions in millimetres

Installation dimensions

Drawer

Inset drawer

NL	SKL	MET
250	240	253
270	260	273
300	290	303
320	310	323
350	340	353
380	370	383
400	390	403
420	410	423
450	440	453
480	470	483
500	490	503
520	510	523
550	540	553
600	590	603

Mounting position for front locking device

Back panel hole

Mounting positions for full extension slide

30 kg

Euro screw Ø 6.3 x 14 mm
Chipboard screw Ø 4 x 16 mm
Screw head Ø 7 mm

LEGEND

HV	Height adjustment	MET	Minimum installation depth
KV	Cabinet front edge	NL	Nominal length
LWK	Inside cabinet width	SKL	Drawer length
LWS	Inside drawer width		

DYNAMOOV TIPMATIC

Full extension slide 30 kg



- Full extension slide Tipmatic for handle-free fronts
- Tipmatic opening unit integrated into the slide
- Excellent running characteristics
- Fully synchronised slide technology
- Integrated height adjustment, tool-free + 3.5 mm
- Integrated front gap adjustment + 1.5 mm
- No damage to the Tipmatic unit when the drawer is pulled open in the conventional way
- Optimal opening by pressing in the central third of the front panel

ORDER INFORMATION

1		Dynamoov full extension slide Tipmatic			
		Set: one left, one right			
NL	30 kg				
	Art. No.				
270	F130101114				
300	F130101115				
350	F130101117				
400	F130101119				
450	F130101121				
500	F130101123				
550	F130101125				

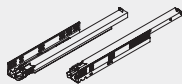

2		Front locking device (1D)			
		Set: one left, one right			
		Art. No.			
		F134140216			

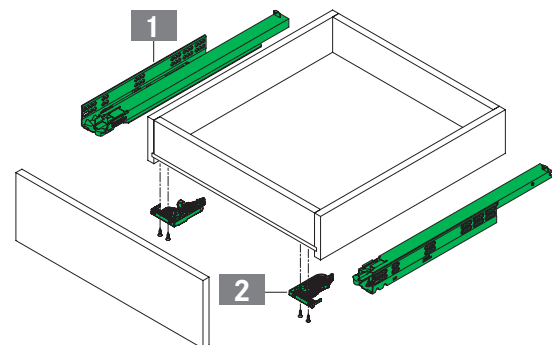

PAGE REFERENCES

Technical information	8
Assembly aids	10

PLANNING DIMENSIONS

All dimensions in millimetres

Installation dimensions	Drawer	NL	SKL	MET
		270	260	273
		300	290	303
		350	340	353
		400	390	403
		450	440	453
		500	490	503
		550	540	553

Inset drawer

Mounting position for front locking device	Back panel hole

Mounting positions for full extension slide	30 kg	Icons	Text
	270 - 300	Euro screw Ø 6.3 x 14 mm Chipboard screw Ø 4 x 16 mm Screw head Ø 7 mm	
	350 - 450		
	500		
	550		

LEGEND

HV	Height adjustment	MET	Minimum installation depth
KV	Cabinet front edge	NL	Nominal length
LWK	Inside cabinet width	SKL	Drawer length
LWS	Inside drawer width		

DYNAMOOV

Technical information

PLANNING DIMENSIONS

Inserting the drawer

Place the drawer on the extended Dynamooov slides and slide in until it audibly engages.

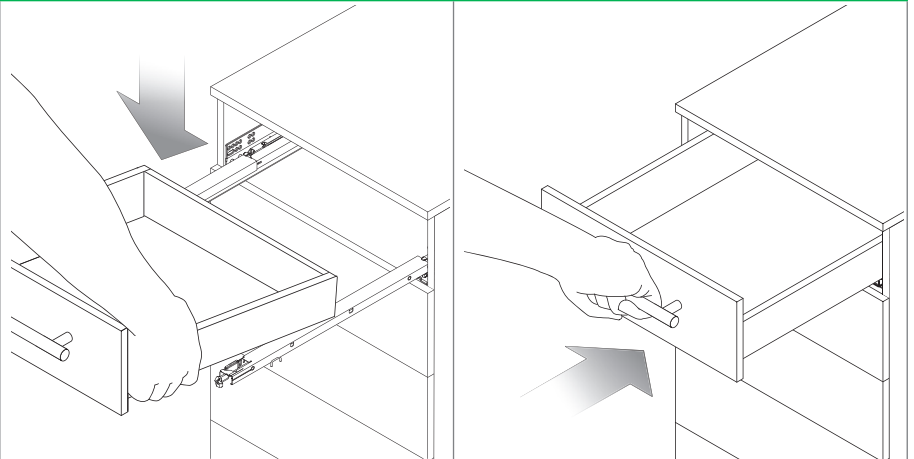

Removing the drawer

Pull out the drawer, actuate the lever of the front locking device on both sides and pull the drawer forwards, away from the slide.

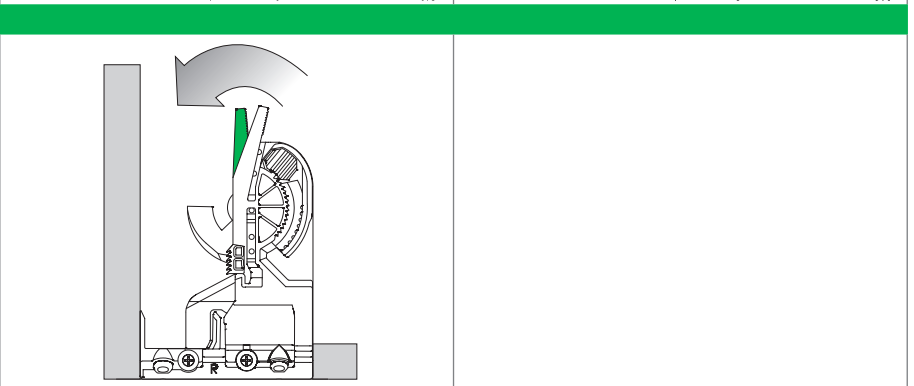

DYNAMOOV TIPMATIC

Front gap adjustment (max. +1.5 mm)

The reliable opening and closing of the drawer depends on the front gap setting (min. 4.5 mm = factory setting). If the front height is greater than 300 mm, the front gap must be increased to the maximum of 6 mm.

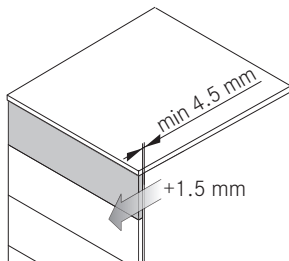

Front gap adjustment from above

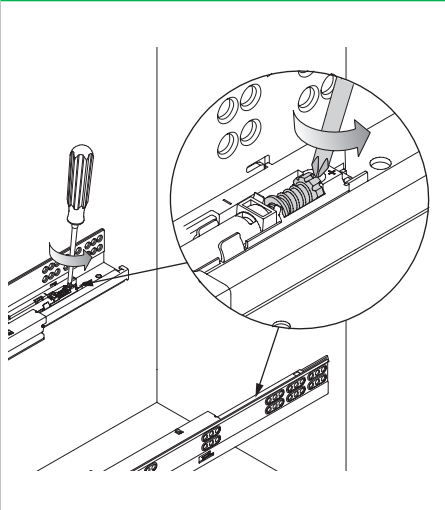

Front gap adjustment from below

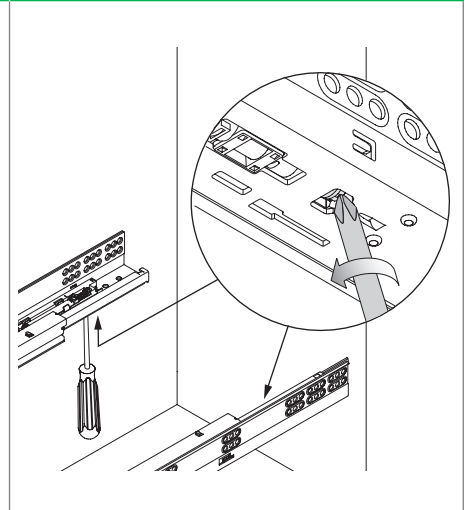

NOTES

Mounting of cabinet members:

The screw recommendations are intended for reference.

Assemblers must ensure that the substrate material is thick enough.

PAGE REFERENCES

Dynamooov Soft-close	4	Assembly aids	10		
Dynamooov Tipmatic	6				

ADJUSTMENT

Height adjustment (max. +3.5 mm)

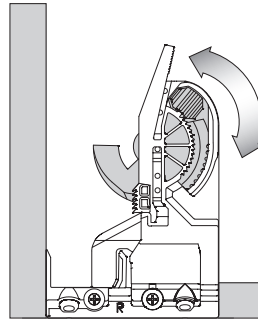
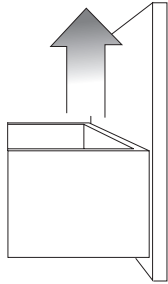

Depth adjustment (max. +3.5 mm)

Can be used for Dynamoov Soft-close/Self-close.

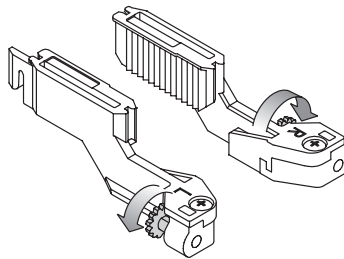
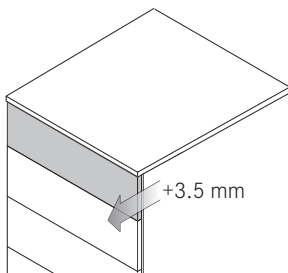

LEGEND

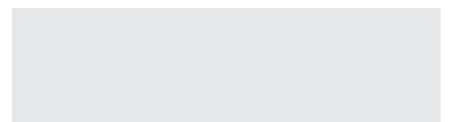
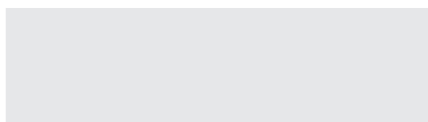
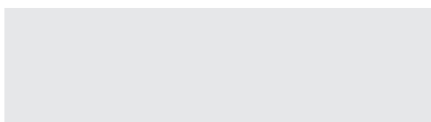

ASSEMBLY AIDS

Dynamoov



DRILLING JIG FOR CABINET RAIL

Guide rule (1 x), stop elements (4 x), stop plates (2 x)

Product type	Art. no.
Drilling jig	F146094730



STOP ELEMENT INDIVIDUAL

- For extension of the drilling jig, cabinet rail F146094730

Product type	Art. no.
Individual marking element	F146094721



DRILLING JIG FOR CABINET RAIL

- For use with pilot drill bit F146035692

Product type	Art. no.
Drilling jig	F146134452



DRILLING JIG, DRAWER

- Pre-drilling of holes for:
 - Front locking device
 - Adjustment adapter
 - Hook-in devices
- For use with centre drill bit F146035692

Product type	Art. no.
Drilling jig	F146133145

PAGE REFERENCES

Dynamoov Soft-close	4
Dynamoov Tipmatic	6

Technical information	8



PILOT DRILL BIT

- The pilot drill bit is used for pre-drilling holes for countersunk chipboard screws

Diameter	Art. no.
2.7 mm	F146035692

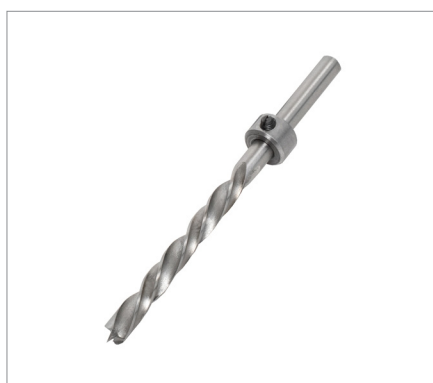

WOOD DRILL BIT WITH STOP RING

- For drilling 5 mm holes, e.g. for Euro screws or expansion anchors
- With adjusting ring for exact determination of the drilling depth
- Length 85 mm

Diameter	Art. no.
5 mm	F146092594



SPECIAL EURO SCREWS

- Steel, nickel-plated, for screwing into a pre-drilled hole system dia. 5 mm (Pozidriv recessed head no. 2)

Nominal diameter x screw length	Art. no.
6.3 x 14 mm	F148115049



SCREWDRIVER

- GRASS cross-head screwdriver (Pozidriv no. 2)

Product type	Art. no.
Screwdriver	F147010256

LEGEND

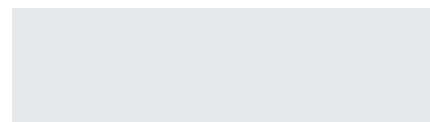
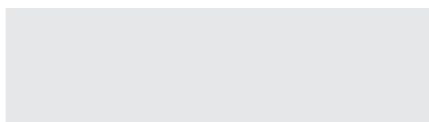
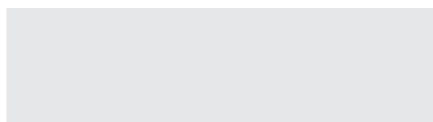

Excellence in
Motion Design.



GRASS GmbH
Movement Systems
Grass Platz 1
6973 Höchst, Austria
T +43 5578 701-0
F +43 5578 701-59
info@grass.eu

grass.eu